

The right fit.

The Strollometer[®] is wireless and straps on and off any stroller. Just follow these simple steps to install your Strollometer on the B.O.B.™ Revolution stroller.

Strollometer console on handlebar

Sensor strapped onto right rear stroller leg, facing forward

Strollometer magnet on inside of right rear wheel

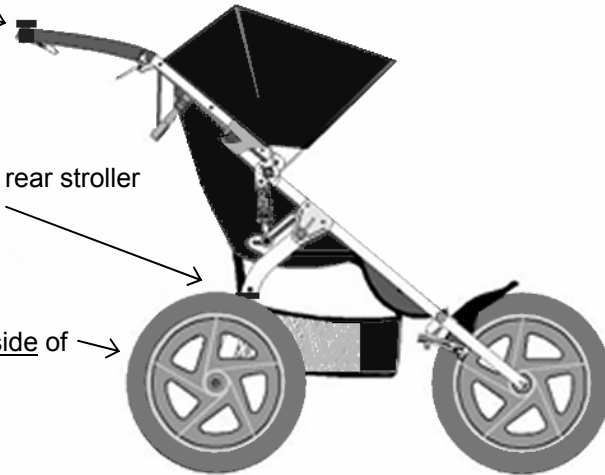

1



Strap console band onto the stroller handlebar.

2

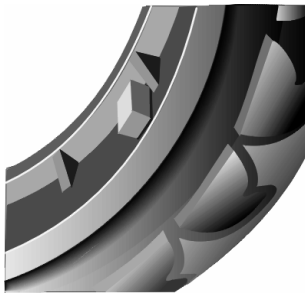

Place adhesive-backed magnet on slanted part of rim, on inside of right-rear wheel.

3



Strap sensor onto stroller leg and position it over magnet. Green light on sensor will blink.